

This addendum covers GRAFIK Eye® 4000 Series Control Units with window treatment zones. It is intended for use with the *GRAFIK Eye* 4000 Series Installer's Guide (P/N 030-615). Please follow these updated instructions, where applicable, when installing GRX-4000 Control Units for control of *Sivoia* and AC Motorized Window Treatments. For control of window treatments, *GRAFIK Eye* Control Units must have software revision 7-0 or higher.

### Identifying the software revision level of the Control Unit

- 1. Enter setup mode.** Press and hold Scene 1 and OFF buttons for about 3 seconds until scene LEDs cycle.
- 2. Check for LS in FADE window.** LS is the first code to appear when you enter setup mode.
- 3. Check the software revision.** Press the TEMPORARY ZONES button. The software revision will be displayed in the FADE window.
- 4. Exit setup mode.** Press and hold Scene 1 and OFF buttons for about 3 seconds until scene LEDs stop cycling.

### Identifying the window treatment load type for each zone

**Note:** This section corresponds to the "Identifying the load types for each zone" section in the *GRAFIK Eye* 4000 Series Installer's Guide (P/N 030-615).

Assigning specific load types is done by using the Circuit Selector located in each dimming panel; however, it is important to set up the zones at the Control Unit to control either dimmable, non-dimmable, or window treatment load types. Please refer to the instructions shipped with each dimming panel for more details.

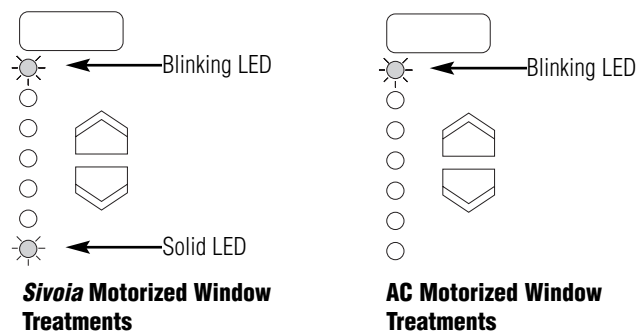

For each window treatment zone, the LEDs can be made to match the load type as shown:

- 1. Enter setup mode.** Press and hold Scene 1 and OFF buttons for about 3 seconds until scene LEDs cycle.
- 2. Check for LS in FADE window.** LS is the first code to appear when you enter setup mode. For the LS mode, ZONE LEDs turn on from top to bottom.
- 3. Set window treatment zone's load type.** Press ZONE ▲ or ▼ until the zone LEDs match the load type in the diagram shown.
- 4. Exit setup mode.** Press and hold Scene 1 and OFF buttons for about 3 seconds until scene LEDs stop cycling.

# How to set up scenes with window treatment zones

**Note:** This section corresponds to the “How to set up lighting scenes” section in the *GRAFIK Eye 4000 Series Installer's Guide* (P/N 030-615).

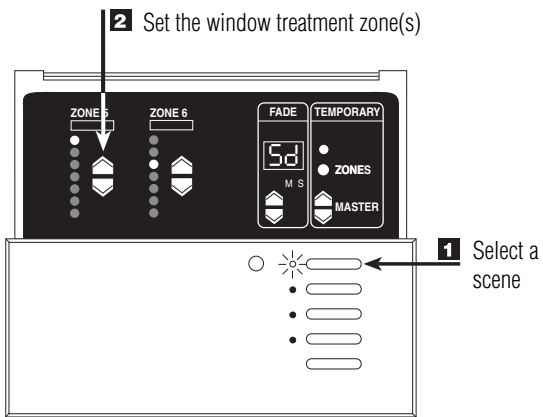

**Note:** Control Unit must be in *5d* mode (see Control Unit instructions for description of modes).

To set up scenes 1 through 4 w/ window treatment zone(s):

**1. Select a scene.** Press the Scene button for the scene you want to adjust. (First button for Scene 1, second button for Scene 2, and so on) The last button is the “Off” Scene.

**Note:** Window treatments **CAN** be set up to use the Off Scene. However, light levels **CANNOT** be set up to change with this scene.

**2. Set the window treatment zone(s) to the appropriate settings.**

For AC Motorized Window Treatments:

Press the ZONE ▲ to set the window treatment to Fully Open (LED 1 & 3 are lit). Press the ZONE ▼ to set the window treatment to Fully Closed (LED 5 & 7 are lit). To set the window treatment zone to Unaffected, press and **HOLD** the ZONE ▼ until the three middle ZONE LEDs are lit (approximately 10 seconds). To take a zone out of Unaffected mode, press and hold ZONE ▼ until the middle three ZONE LEDs are no longer lit (approximately 10 seconds).

**Stop Functionality:** Pressing ZONE ▲ a second time during scene set up will stop the window treatment, and different ZONE LEDs will be lit (instead of 1 & 3, LEDs 3 & 5 will be lit). However, this change is **NOT** permanent - the window treatment zone will still be set to Fully Open and will react accordingly upon scene selection. The same applies when selecting ZONE ▼ twice for Fully Closed.

For Sivoia Motorized Window Treatments:

The zone can be programmed to any of the presets of the *Sivoia* system. To program a zone to Open in a certain scene, press the ZONE ▲ until the top LED is lit. For Preset 1, use the ZONE ▲ or ▼ until the second LED from the top is lit. For Preset 2, the third LED is lit. For Preset 3, the fourth LED is lit. To program a zone to Close in a certain scene, press the ZONE ▼ until the bottom LED is lit. To set the window treatment zone to Unaffected, make sure the bottom ZONE LED is lit (Close setting), then press and hold ZONE ▼ until the middle three ZONE LEDs are lit (approximately 10 seconds). To take a zone out of Unaffected mode, press and hold ZONE ▼ until the middle three ZONE LEDs are no longer lit (approximately 10 seconds).

**Note:** If the ZONE ▲ is pressed and held for about 3 seconds, the window treatment setting for that zone will jump to Open. If the ZONE ▼ is pressed and held (while not in the Closed state) for about 3 seconds, the window treatment setting for that zone will jump to Closed.

## AC Motorized Window Treatments

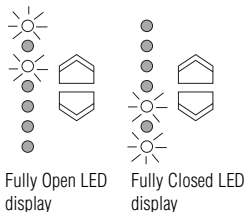

## i Motorized Window Treatments

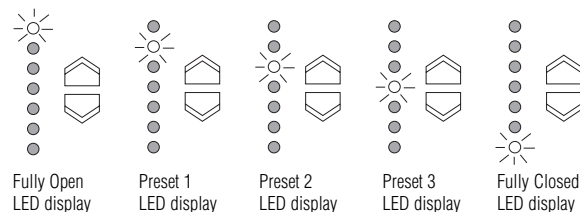

## Sivoia and AC Motorized Window Treatments

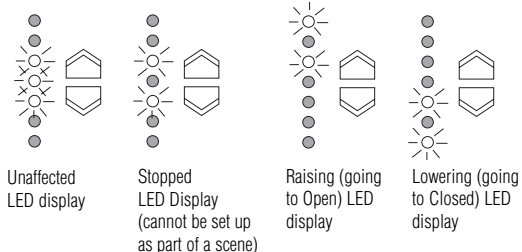

## Notes:

- Window treatment zones are NOT affected by the Fade-in setting. However, lighting zones will fade accordingly as scenes are selected. See Control Unit instructions for details on Fade-in setting.
- To program scenes 5 through 16, refer to “Advanced Scene Programming Options” section in the *GRAFIK Eye 4000 Series Installer's Guide* (P/N 030-615).

## How to adjust a window treatment zone temporarily

**Note:** This section corresponds to the “How to adjust light levels temporarily” section in the *GRAFIK Eye 4000 Series Installer's Guide* (P/N 030-615).

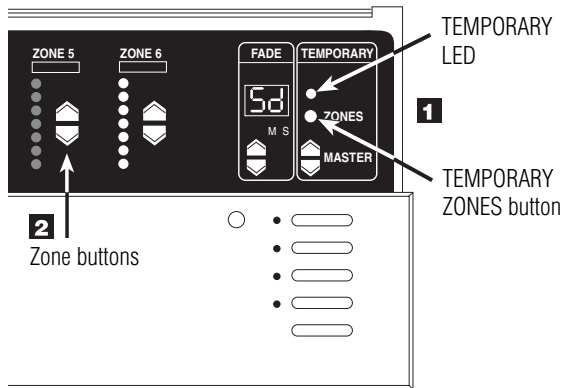

**Note:** Control Unit must be in either 5d or 5b mode (see Control Unit instructions for description of modes).

To adjust a window treatment zone:

1. If the TEMPORARY LED is not already lit, press the TEMPORARY ZONES button. The LED above this button will light.
2. Press ZONE ▲ or ▼ to change the position of the Window Treatment. For AC Motorized Window Treatments, pressing ZONE ▲ or ▼ a second time will stop the movement of the window treatment, and different ZONE LEDs will be lit (instead of 1 & 3, LEDs 3 & 5 will be lit).

**Note:** All adjustments made in temporary mode remain only until a new scene selection occurs—the *GRAFIK Eye Control Unit* does not store them as permanent scene settings.

Internet: [www.lutron.com](http://www.lutron.com)  
E-mail: [product@lutron.com](mailto:product@lutron.com)

**WORLD HEADQUARTERS**  
Lutron Electronics Co. Inc.,  
TOLL FREE: (800) 523-9466  
(U.S.A., Canada, Caribbean)  
Tel: (610) 282-3800;  
International 1- 610-282-3800  
Fax: (610) 282-3090;  
International 1-610-282-3090

**GREAT BRITAIN**  
Lutron EA Ltd.,  
Tel: (207) 702-0657;  
International 44-207-702-0657  
Fax: (207) 480-6899;  
International 44-207-480-6899

**GERMANY**  
Lutron Electronics GmbH  
Tel: (309) 710-4590;  
International 49 309 710-4590  
Fax: (309) 710-4591;  
International 49 309 710-4591

**ASIAN HEADQUARTERS**  
Lutron Asuka Corporation  
Tel: (03) 5405-7333;  
International 81-3-5405-7333  
Fax: (03) 5405-7496;  
International 81-3-5405-7496

**HONG KONG SALES OFFICE**  
Lutron GL (Hong Kong)  
Tel: 2104-7733;  
International 852-2104-7733  
Fax: 2104-7633;  
International 852-2104-7633

**SINGAPORE**  
Lutron GL (Singapore)  
Tel: 65 220 4666  
Fax: 65 220 4333

#### **LIMITED WARRANTY**

Lutron will, at its option, repair or replace any unit that is defective in materials or manufacture within one year after purchase. For warranty service, return unit to place of purchase or mail to Lutron at 7200 Suter Rd., Coopersburg, PA 18036-1299, postage pre-paid.

**This warranty is in lieu of all other express warranties, and the implied warranty of merchantability is limited to one year from purchase. This warranty does not cover the cost of installation, removal, or reinstallation, or damage resulting from misuse, abuse, or improper or incorrect repair, or damage from improper wiring or installation. This warranty does not cover incidental or consequential damages. Lutron's liability on any claim for damages arising out of or in connection with the manufacture, sale, installation, delivery, or use of the unit shall never exceed the purchase price of the unit.**

This warranty gives you specific legal rights, and you may also have other rights which vary from state to state. Some states do not allow limitations on how long an implied warranty lasts, so the above limitation may not apply to you. Some states do not allow the exclusion or limitation of incidental or consequential damages, so the above limitation or exclusion may not apply to you.

Lutron, GRAFIK Eye, and Sivoia are registered trademarks of Lutron Electronics Co., Inc.  
© 2002 Lutron Electronics Co., Inc.

**LUTRON®**

Lutron Electronics Co., Inc.  
Made and printed in U.S.A.  
P/N 032-106 Rev. B 5/02